

Volunteer Recruitment Fair Venue Map
St Paul's and St George's Church

- Public entrance, foyer and reception area
- Main hall and stage area for stalls
- Café by bespoke organic events (boe)
- 1 6 Stalls (purple indicates stalls with electricity points)
- i Information on fair and volunteering
- WC Public toilets
- A Access to workshops on upper level
25 to 30 seat capacity (theatre style)

- Ramp access to stage area
- Stairs to lower and upper levels
- Lift for stall holder access from side entrance
- 🚗 Stall holder drop-off points **
- ♿ Disabled access *
- 🚌 Lothian Buses bus stop (tram stop adjacent)

Mon - Sat
8.00am - 6.30pm

No loading
Mon - Fri
8.00am - 9.15am
4.30pm - 6.30pm

Loading only
Mon - Fri
9.15am - 4.30pm
Sat
8.00am - 6.30pm

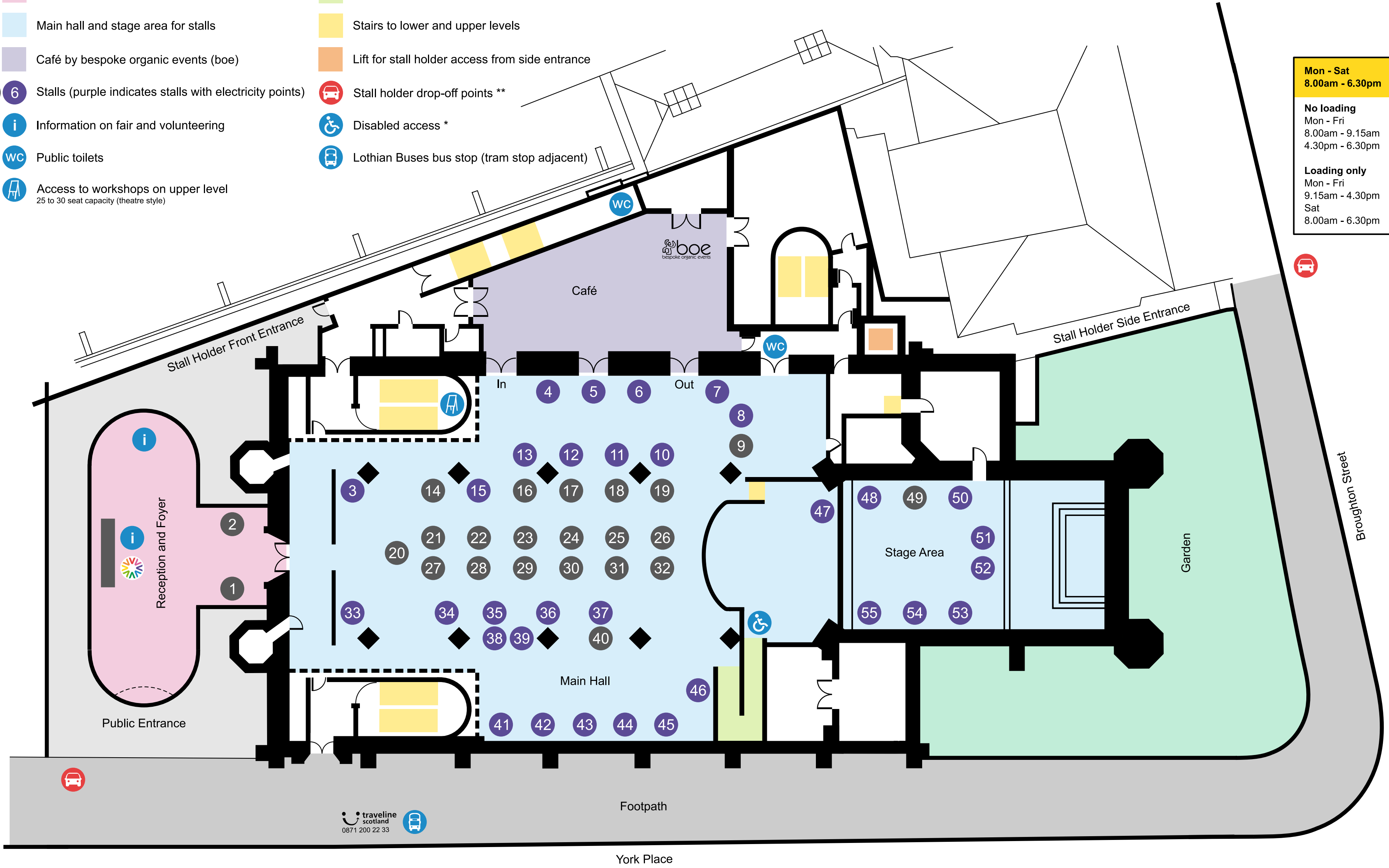

* The venue is fully accessible with ramp access to the stage area marked on the map. If you do require assistance please ask a Volunteer Edinburgh staff member or volunteer (look out for our rainbow coloured logo).

** Stall holders may deliver materials at the two locations marked on the map. The drop-off point outside the public entrance should **only** be used if clear, and for **very short** periods. There is a second drop-off point accessed from Broughton Street via the side entrance, with lift access to the main hall. Please press the buzzer to access the venue from this side entrance and ask for **Eilidh Matheson** or call **0131 524 0135**.